

PLAIN PATTERN

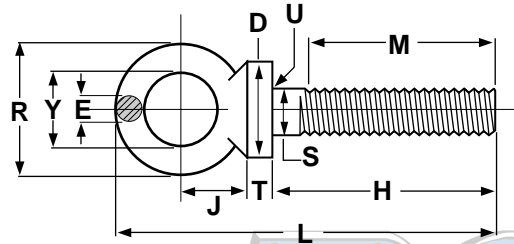

SHOULDER PATTERN

FORGED EYEBOLTS, PLAIN PATTERN											ANSI/ASME B18.15
Nominal Size	Shank Dia.	Shank Length		Eye ID	Nominal Eye OD	Eye Sect. Diameter	Overall Length	Min Length Full Thread		Thread Size UNC-2A	
		Long Length	Short Length					Long Length	Short Length		
		1/4	0.25					0.25 0.28	1.00 1.06		1.00 1.06
5/16	0.31	0.31 0.34	1.12 1.19	1.06 1.13	0.81 0.94	1.44	0.25 0.31	2.44 2.75	0.81	0.75	5/16-18 or .3125-18
3/8	0.38	0.38 0.41	1.25 1.38	1.12 1.25	0.94 1.06	1.69	0.31 0.38	2.81 3.19	0.88	0.75	3/8-16 or .375-16
7/16	0.44	0.44 0.47	1.38 1.50	1.13 1.25	1.00 1.12	1.81	0.34 0.41	3.06 3.44	1.00	0.75	7/16-14 or .4375-14
1/2	0.50	0.50 0.53	1.50 1.62	1.13 1.25	1.12 1.25	2.12	0.44 0.50	3.50 3.88	1.12	0.75	1/2-13 or .500-13
9/16	0.56	0.56 0.59	1.62 1.75	1.21 1.34	1.19 1.31	2.25	0.47 0.53	3.75 4.12	1.25	0.84	9/16-12 or .5625-12
5/8	0.62	0.62 0.66	1.75 1.88	1.31 1.44	1.31 1.44	2.56	0.56 0.62	4.19 4.56	1.38	0.94	5/8-11 or .625-11
3/4	0.75	0.75 0.78	2.00 2.12	1.50 1.62	1.44 1.56	2.81	0.62 0.69	4.69 5.06	1.62	1.13	3/4-10 or .750-10
7/8	0.88	0.88 0.91	2.25 2.38	1.75 1.88	1.56 1.69	3.19	0.75 0.81	5.31 5.69	1.81	1.31	7/8-9 or .875-9
1	1.00	1.00 1.06	2.50 2.62	1.94 2.06	1.69 1.81	3.56	0.88 0.94	5.94 6.31	2.06	1.50	1-8 or 1.000-8
1-1/8	1.12	1.12 1.19	2.75 2.88	2.13 2.26	1.94 2.06	4.06	1.00 1.06	6.69 7.06	2.31	1.69	1-1/8-7 or 1.125-7
1-1/4	1.25	1.25 1.34	3.00 3.12	2.38 2.50	2.12 2.25	4.44	1.09 1.16	7.31 7.69	2.50	1.88	1-1/4-7 or 1.250-7
1-1/2	1.50	1.50 1.59	3.50 3.62	2.75 2.87	2.44 2.56	5.19	1.31 1.38	8.56 8.94	3.00	2.25	1-1/2-6 or 1.500-6
1-3/4	1.75	1.75 1.84	3.75 3.88	3.18 3.31	2.75 3.00	6.00	1.50 1.62	9.50 10.12	3.19	2.62	1-3/4-5 or 1.750-5
2	2.00	2.00 2.09	4.00 4.25	3.62 3.87	3.06 3.44	6.88	1.75 1.88	10.56 11.44	3.38	3.00	2-4-1/2 or 2.000-4.50
2-1/2	2.50	2.50 2.62	5.00 5.25	4.50 4.75	3.81 4.19	8.50	2.19 2.31	13.19 14.06	4.25	3.75	2-1/2-4 or 2.500-4

FORGED EYEBOLTS, SHOULDER PATTERN

ANSI/ASME
B18.15

Nominal Size	S		H		Y	R	E	L	M		Thread Size UNC-2A	J	D	T	U
	Shank Diam.	Shank Length		Eye ID	Nominal Eye OD	Eye Sect. Diam.	Overall Length	Min Length Full Thread		Center line Eye To Shoulder		Shoulder Diam.	Shoulder Height	Radius Under Shoulder	
		Long Length	Short Length					Long Length	Short Length						
1/4	0.25	0.25 0.28	1.00 1.06	1.00 1.06	0.69 0.81	1.19	0.19 0.25	2.22 2.53	0.75	0.75	1/4-20 or .250-20	0.69 0.81	0.50 0.56	0.12 0.19	0.015 0.025
5/16	0.31	0.31 0.34	1.12 1.19	1.06 1.13	0.81 0.94	1.44	0.25 0.31	2.66 2.97	0.81	0.75	5/16-18 or .3125-18	0.88 1.00	0.56 0.62	0.12 0.19	0.015 0.025
3/8	0.38	0.38 0.41	1.25 1.38	1.12 1.25	0.94 1.06	1.69	0.31 0.38	3.09 3.47	0.88	0.75	3/8-16 or .375-16	1.06 1.19	0.62 0.69	0.12 0.19	0.015 0.025
7/16	0.44	0.44 0.47	1.38 1.50	1.13 1.25	1.00 1.12	1.81	0.34 0.41	3.41 3.78	1.00	0.75	7/16-14 or .4375-14	1.19 1.31	0.75 0.81	0.19 0.25	0.015 0.025
1/2	0.50	0.50 0.53	1.50 1.62	1.13 1.25	1.12 1.25	2.12	0.44 0.50	3.81 4.19	1.12	0.75	1/2-13 or .500-13	1.31 1.44	0.88 0.94	0.19 0.25	0.015 0.025
9/16	0.56	0.56 0.59	1.62 1.75	1.21 1.34	1.19 1.31	2.25	0.47 0.53	4.19 4.56	1.25	0.84	9/16-12 or .5625-12	1.50 1.62	0.94 1.00	0.22 0.28	0.020 0.045
5/8	0.62	0.62 0.66	1.75 1.88	1.31 1.44	1.31 1.44	2.56	0.56 0.62	4.56 4.94	1.38	0.94	5/8-11 or .625-11	1.59 1.72	1.00 1.06	0.25 0.31	0.020 0.045
3/4	0.75	0.75 0.78	2.00 2.12	1.50 1.62	1.44 1.56	2.81	0.62 0.69	5.06 5.50	1.62	1.12	3/4-10 or .750-10	1.72 1.91	1.12 1.25	0.25 0.31	0.020 0.045
7/8	0.88	0.88 0.91	2.25 2.38	1.75 1.88	1.56 1.69	3.19	0.75 0.81	5.75 6.19	1.81	1.31	7/8-9 or .875-9	2.03 2.22	1.31 1.44	0.31 0.38	0.040 0.065
1	1.00	1.00 1.06	2.50 2.62	1.94 2.06	1.69 1.81	3.56	0.88 0.94	6.44 6.88	2.06	1.50	1-8 or 1.000-8	2.22 2.41	1.50 1.62	0.38 0.44	0.060 0.095
1-1/8	1.12	1.12 1.19	2.75 2.88	2.13 2.26	1.94 2.06	4.06	1.00 1.06	7.31 7.75	2.31	1.69	1-1/8-7 or 1.125-7	2.59 2.78	1.69 1.81	0.44 0.50	0.060 0.095
1-1/4	1.25	1.25 1.34	3.00 3.12	2.38 2.50	2.12 2.25	4.44	1.09 1.16	8.00 8.44	2.50	1.88	1-1/4-7 or 1.250-7	2.84 3.03	1.88 2.00	0.50 0.56	0.060 0.095
1-1/2	1.50	1.50 1.59	3.50 3.62	2.75 2.87	2.44 2.56	5.19	1.31 1.38	9.22 9.72	3.00	2.25	1-1/2-6 or 1.500-6	3.19 3.44	2.12 2.25	0.50 0.62	0.060 0.095
1-3/4	1.75	1.75 1.84	3.75 3.88	3.18 3.31	2.75 3.00	6.00	1.50 1.62	10.50 11.12	3.19	2.62	1-3/4-5 or 1.750-5	3.88 4.12	2.50 2.62	0.50 0.62	0.060 0.095
2	2.00	2.00 2.09	4.00 4.12	3.62 3.79	3.06 3.44	6.88	1.75 1.88	11.53 12.22	3.38	3.00	2-4-1/2 or 2.000-4.50	4.25 4.50	2.88 3.00	0.62 0.75	0.060 0.095

Description	A forged bolt without welds, with a head in the form of an open or closed anchor ring. Bolt shall have a unified thread pitch. Shoulder pattern eyebolts shall have an unthreaded shoulder below the anchor ring which is greater in diameter than the threaded shank.
Applications/ Advantages	Used in applications where a forged shank is required, ie. in a rigging when mounted atop a uniformly distributed weight.
Material	Eyebolts shall be made from a carbon steel which conforms to the following chemical composition requirements-- <i>Carbon</i> : 0.48% maximum; <i>Manganese</i> : 1.00% maximum; <i>Phosphorus</i> : 0.040% maximum; <i>Sulfur</i> : 0.050 maximum; <i>Silicon</i> : 0.15-0.35%
Heat Treatment	Bolts shall be liquid quenched and tempered before machining the threaded end.
Grain Size	ASTM No. 5 or finer
Tensile Strength	65,000 - 85,000 psi.
Yield Strength	30,000 psi. minimum
Elongation in 2 in.	30% minimum
Reduction of Area	60% minimum
Plating	See Appendix-A for plating information.